

RO4000 Assembly

Diagram 1 - Labelled Assembly of Quality Components

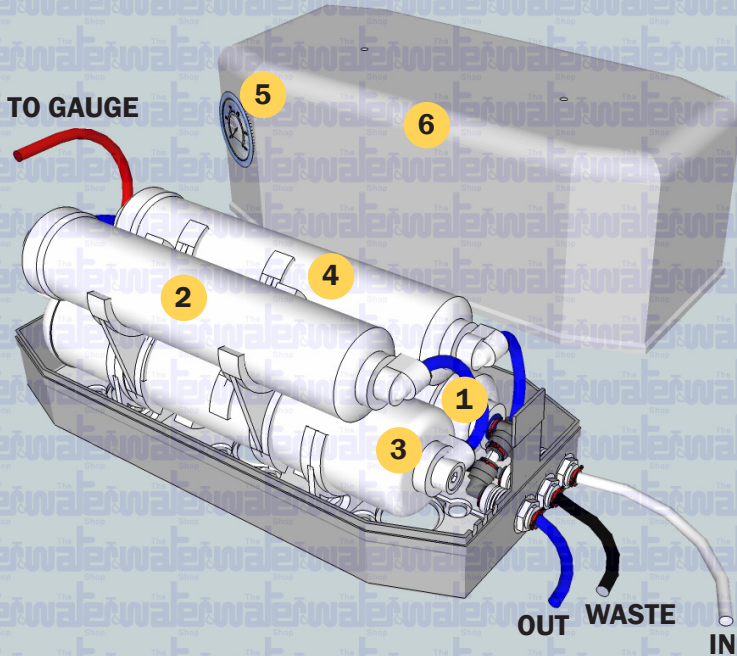
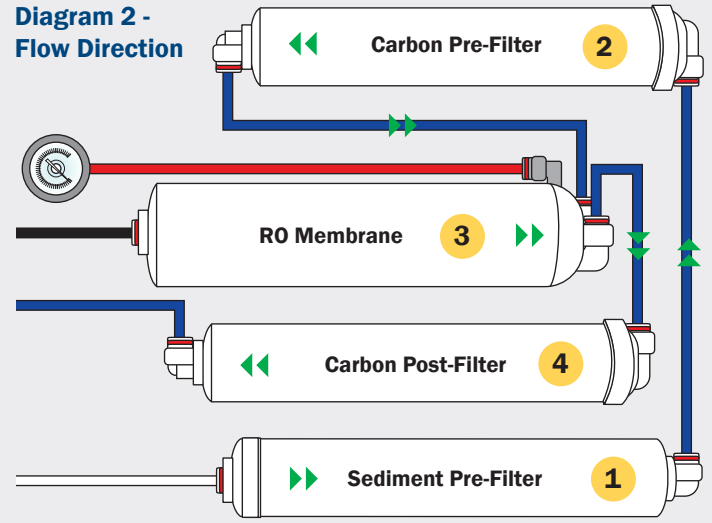


Diagram 2 - Flow Direction



Components

1	Sediment Pre-Filter	4	Carbon Post Filter
2	Carbon Pre-Filter	5	Pressure Gauge
3	RO Membrane	6	Plastic Cover

Step by Step Maintenance

- 1 Remove the cover by compressing the clips at each end of the unit.
- 2 Disconnect the red hose that connects the RO Membrane to the pressure gauge.
- 3 Disconnect the Sediment Pre-Filter 1. Taking note of the inlet hose, replace with the **new** Sediment Pre-Filter. Ensure the flow direction is correct (see **Diagram 2**).
- 4 Disconnect and dispose of the Carbon Pre-Filter 2 taking note of the inlet hose. Insert hose into inlet of the new Carbon Pre-Filter. Ensure the flow direction is correct (see **Diagram 2**). Leaving the outlet **disconnected**, allow to run for a few minutes to flush the cartridge. This will flush the carbon fines inherent in the new Carbon Pre-Filter, preventing premature clogging of the RO Membrane 3.
- 5 Insert hose into the outlet of the new Carbon Pre-Filter 2.
- 6 Disconnect the Carbon Post-Filter 4. Taking note of the hose inlet's, replace with new Carbon Post-Filter. Ensure the flow direction is correct (see **Diagram 2**). Flush the system for a few minutes before drinking.

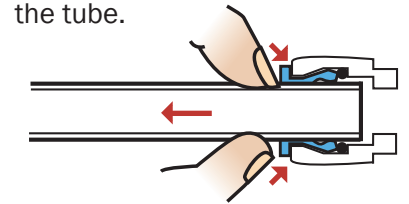
Your TFC RO Membrane 3 should last 3-6 years depending on water quality and usage. Your pure water quality can be tested with a conductivity meter measuring total dissolved solids (TDS) from the RO Membrane (pure water) outlet, this will indicate the rejection of contaminants ratio. TDS Testing is a complimentary service at our show rooms listed below.

Make sure the end of the tube is cut square and straight, ensuring it has an even, clean surface.

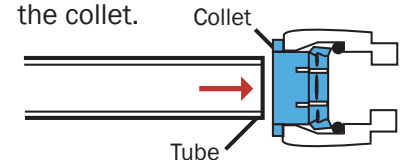


Diagram 3 - Tube Connections

- 1 **To remove the tube** - First remove the red clip. Use two fingers to push onto the collet and at the same time pull out the tube.



- 2 **To make the connection** - push the tube firmly into the collet.



- 3 Make sure the tube is pushed as far as it can go and secure with a red clip.

