

Ceramic Twin Undersink

Installing Your Premium Water Filter System

PLEASE READ CAREFULLY BEFORE ATTEMPTING INSTALLATION

Undersink Setup

- 1** Housing
- 2** Chrome Faucet
- 3** Stainless Steel Bracket
- 4** Pressure Limiting Valve
- 5** Tee Piece
- 6** Ministop Valve
- Red Clips
- A** 1/4" red tube connects the feed water valve to the pre-filter.
- B** 1/4" blue tube connects the post filter to the chrome faucet.

Diagram 1

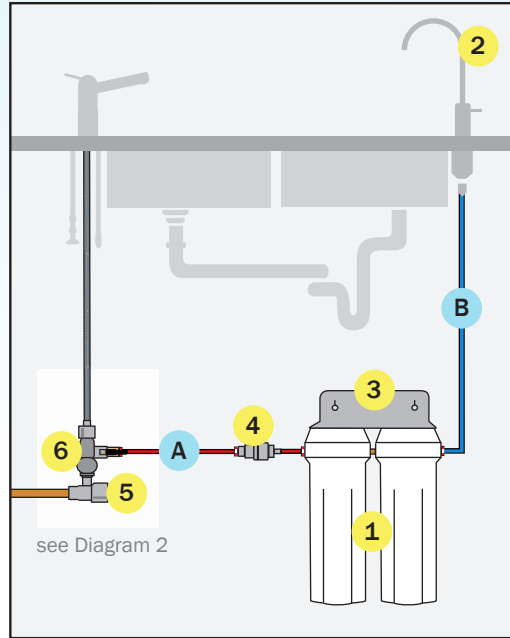
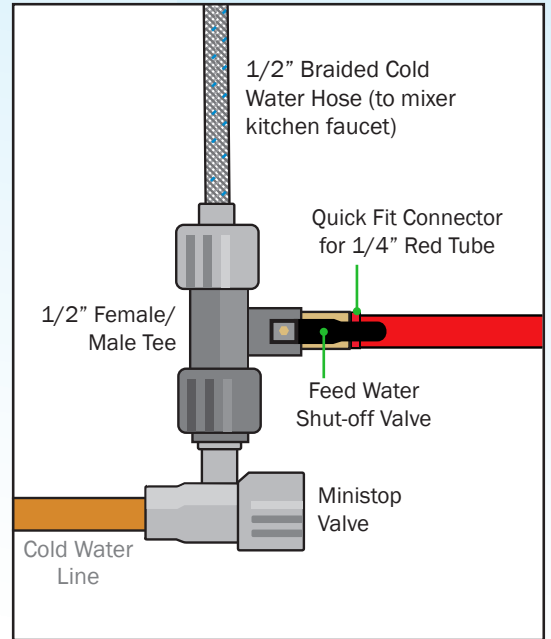

Diagram 2



Step by Step Installation

- 1. Installing your undersink system** - Taking into consideration ease of maintenance, find a convenient location beneath the benchtop. Using the selftapping screws provided, attach the filter to the cupboard wall (allowing approx 50mm height for servicing). The system may otherwise stand freely on the cupboard floor.
- 2. Shut Off the Water Supply** - Locate the water ministop valve (see Diagram 1) for the cold water feed line. (To identify the hot and cold water pipes, turn on the hot water at the faucet. After the water is warm to the touch, feel the pipes under the sink).

Close the cold water ministop valve. Turn on the cold water at the faucet to assure that the line is completely shut off and drained. (If there is no cold water ministop

valve located under the sink, it is necessary to turn off the main water supply at the entry to the house).

▲ Warning: This unit must be installed on the **COLD** water line.

3. Unscrew braided hose from ministop valve (see Diagram 2). Screw in the female/male tee to the ministop valve and re-attach the braided hose.
4. **Connect the System** - To make a connection, the tube is simply pushed in by hand. Please refer to Diagram 3. Where possible, leave tubing long, do not cut to an exact length. Ensure cut is straight and square with a clean surface.

Diagram 3 - Tube Connections

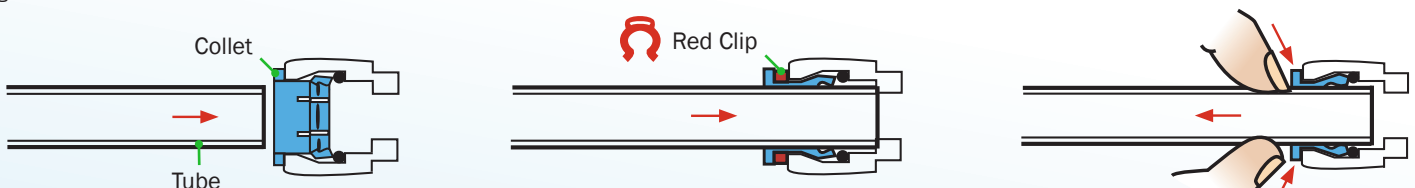

1. To make the connection, push the tube firmly into the collet.

2. Make sure the tube is pushed as far as it can go and secure with a John Guest red clip.

3. **To remove the tube** - First remove the red clip. Use two fingers to push onto the collet and at the same time pull out the tube.

Ceramic Twin Undersink

Diagram 4 - Faucet Installation

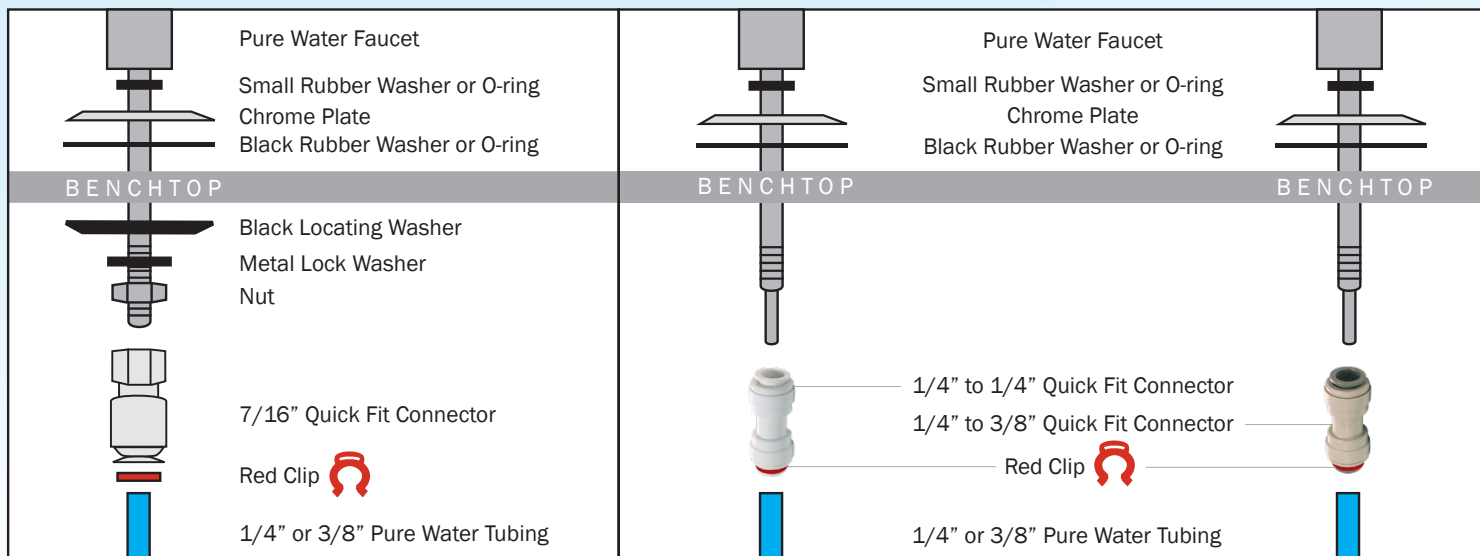

5. **Faucet Installation** - The pure water faucet may be installed on any flat surface over 50mm (2") in diameter. (Remember: check the underside of the location for interference). Make a small indent using a centre punch to mark the desired drilling location. Drill a pilot hole with a metal drill. Enlarge the hole using a 1/2" metal drill bit.

6. Once the hole has been drilled install the faucet as per Diagram 4. Be sure the faucet body, chrome plate, and the black rubber washer are placed above the sink.

7. Install female Quick Fit Connector to the end of the faucet (see Diagram 4).

8. **Activating the system for the first time** - Once all tubing has been connected, place the pure water faucet in the on position, then open the ministop valve slowly. This will allow any trapped air to escape. Check plumbing assembly and the undersink system are secure and free from leakage.

If there are no detected leaks, leave the pure water running for a few minutes to flush the new filter cartridges. Water may be slightly discoloured and have some aeration, this is normal and will clear shortly.

9. Allow the system to stand for 2 to 3 hours and then flush again for several minutes. Your system is now operational.

Available extra for the Ceramic Twin Undersink

Leak Stopper & Filter Life Monitor

Leak Stopper - When moisture is detected by the metal contacts the alarm is triggered and the unit activates the solenoid valve to shut off the water supply to the filter system. The Leak Warning indicator will continuously blink blue. The alarm will continue to sound until the unit is manually reset.

Filter Life Monitor - Have peace of mind knowing when to change your water filter cartridges. Depending on the life remaining within your filter cartridge the Cartridge Maintenance Indicator will signal a different coloured light.



North Shore Showroom
245 Miller Street. Cammeray NSW 2062

Inner West Showroom
342-350 Parramatta Road, Stanmore NSW 2048

02 9458 1111 sales@watershop.com.au www.watershop.com.au