

Quick Change Series

Replacing Your Q Series Filter Cartridges

PLEASE READ CAREFULLY BEFORE ATTEMPTING MAINTENANCE

Undersink Setup

- 1** Ministop Valve
 - 2** Tee Piece
 - 3** Pressure Limiting Valve
 - 4** Stainless Steel Bracket
 - 5** Filter Cartridges/Housing
 - 6** Chrome Faucet
- A** 1/4" blue tube connects the feed water valve to the pre-filter.
 - B** 1/4" blue tube connects the post filter to the chrome faucet.

Diagram 1

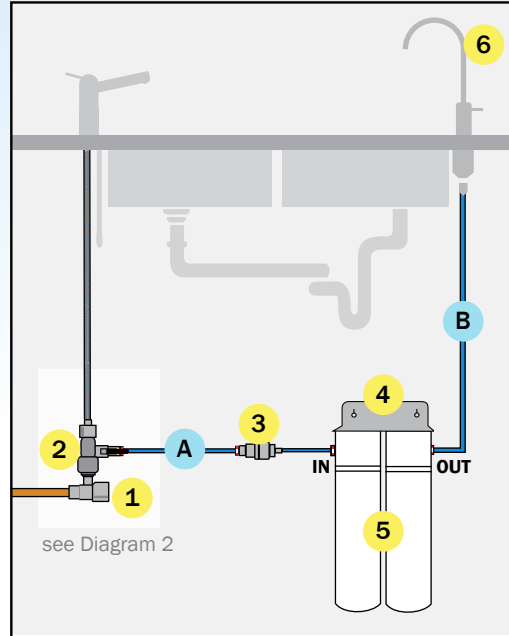
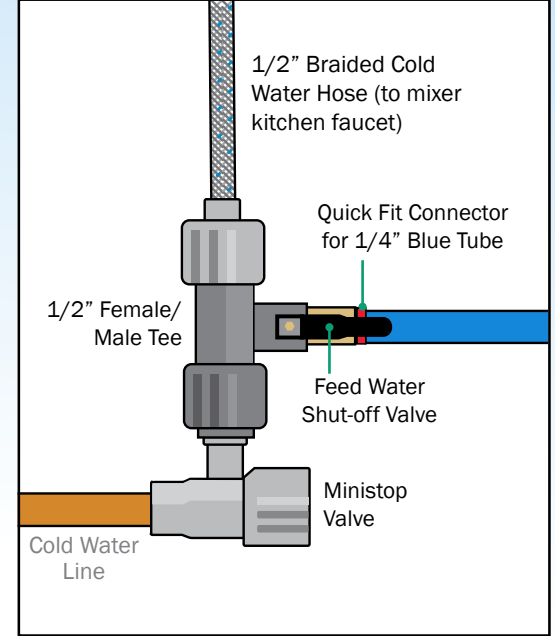

Diagram 2



Step by Step Instructions

These instructions apply to the Q-Series Single and Twin Systems.



'Twist-Off' cartridges

Ensure a simple, hygienic, no mess means of system maintenance.

1. Shut off water supply to the system by turning the feed water valve off. Turn on the pure water faucet to release any pressure.
2. Taking note of the direction indicated on the filter label, unscrew ('twist-off') the filter body, removing it from the head assembly and dispose.



Please ensure the yellow dust plug in the head of any new filter cartridge is removed before installation.

3. Having removed the yellow dust plugs from your new filter cartridge, install it into the same position within the head assembly.
4. Turn the feed water valve on slowly.
5. Open the pure water faucet and allow to run for a few minutes to flush the system. Dis-colouration and aeration may occur - this is normal and occurs when the non-toxic carbon fines and oxygen are flushed from the new cartridges.
6. Check for leaks (it is recommended to do this periodically).

NOTE: Carbon cartridges may contain a small amount of carbon fines (very fine black powder). Hence, after installation, a new cartridge should be flushed with sufficient water to remove the fines before using the water. Water may appear milky for the first few days - this is only oxygen that is released from the carbon. It's safe to drink and it will clear in a few days.

Quick Change Series

How to Remove & Replace O-Rings

These instructions are suitable for Q Series filter cartridges, made in USA.

It is essential that O-rings are maintained and/or replaced periodically to ensure ease of maintenance and avoid leaks. Note: Removing O-rings with a sharp tool can damage the O-ring and/or its groove and subsequently allow leaking.

Within a Quick Change Head assembly there are two O-rings. See Diagram 3.

To Remove O-ring **A** :

Insert a soft material/blunt tool between the inside of the O-ring and its groove. Then, slide the tool around the inside of the groove, causing the O-ring to pop up. If necessary hold a side of the O-ring to prevent it revolving within the groove.

To Remove O-ring **B** :

Again, using a soft material/blunt tool preferably with a form of hook, insert the tool between the inside of the O-ring and its groove. Hooking the O-ring with the tool, pull the O-ring up and out.

To Re-Use/Replace an O-ring:

Inspect the O-ring carefully and clean; wiping gently with a lint-free material. Lightly lubricate the O-ring with a fine coat of silicone grease or olive oil. Push the O-ring back into its groove. Using your finger, run over and around the O-ring, ensuring it is sitting level within its groove.

Diagram 3

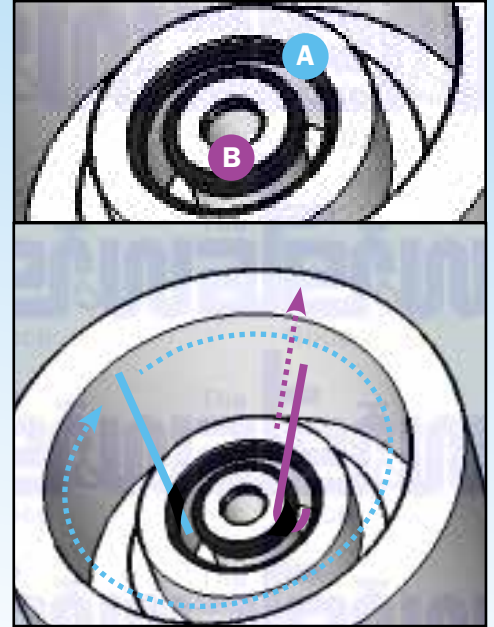

- Tool
- ⋯→ Action to remove **A** O-ring
- Tool (with hook)
- ⋯→ Action to remove **B** O-ring

Tube Connections

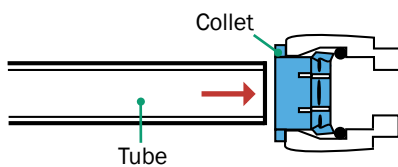

1. To make the connection, push the tube firmly into the collet.

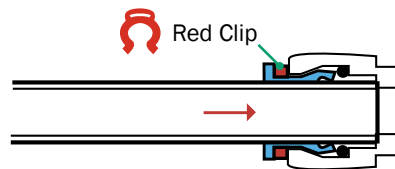

2. Make sure the tube is pushed as far as it can go and secure with a John Guest red clip.

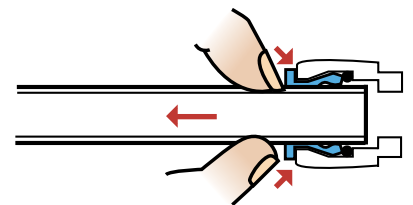

3. **To remove the tube** - First remove the red clip. Use two fingers to push onto the collet and at the same time pull out the tube.

Make sure the end of the tube is cut straight, ensuring it has an even, clean surface. It is recommended to **not** shorten the tubes.



North Shore Showroom
425 Miller Street, Cammeray NSW 2062

Inner West Showroom
350 Parramatta Road, Stanmore NSW 2048

02 9458 1111 sales@watershop.com.au www.watershop.com.au